

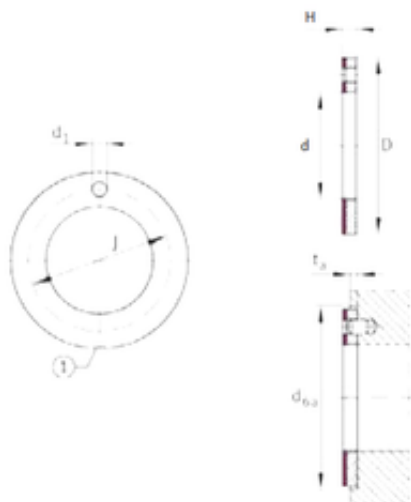

## Bearing Rolamentos do Brasil Ltda.



### INA EGW38-E40 plain bearings

Bearing No. EGW38-E40

Size	38x62x1.5 mm
Bore Diameter	38 mm
Outer Diameter	62 mm
Width	1,5 mm
d	38 mm
D	62 mm
H	1,5 mm
t	1 mm
d1	4 mm
J	50 mm
da	62 mm
Category	Sleeve Bearings
Inventory	0.0
Manufacturer Name	SCHAEFFLER GROUP
Minimum Buy Quantity	N/A
Weight / Kilogram	0.026
EAN	4012802756159
Product Group	B04264
Profile	Thrust Washer
Material Description	Steel Backing, Bronze Innerstructure, PTFE-lead Overlay
Material	Permaglide P10
Inch - Metric	Metric
Long Description	38MM Nominal Bore; 62MM Nominal Outside Diameter; 1.5MM Length Thru Bore; Thrust Washer

EGW38-E40 Bearing 2D drawings and 3D CAD models



## Bearing Rolamentos do Brasil Ltda.

	Profile; Steel Backing, Bronze Innerstructure, PTFE-lead Overlay; Permaglide P10 Material
Category	Sleeve Bearings
UNSPSC	31171515
Harmonized Tariff Code	84833080
Noun	Bearing
Keyword String	Plain
Manufacturer URL	<a href="http://www.ina.com">http://www.ina.com</a>
Manufacturer Item Number	PAW38P10
Weight / LBS	0.058
Nominal Bore	1.496 Inch   38 Millimeter
Length Thru Bore	0.059 Inch   1.5 Millimeter
Nominal Outside Diameter	2.441 Inch   62 Millimeter