

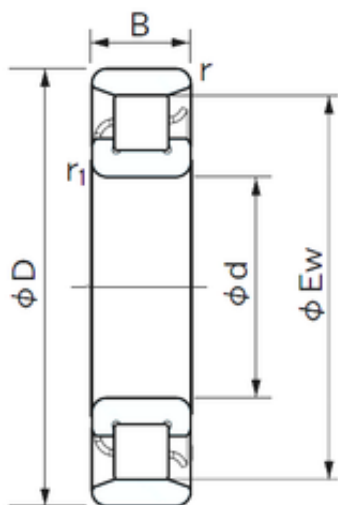

Bearing Rolamentos do Brasil Ltda.



70 mm x 125 mm x 24 mm NACHI N 214
cylindrical roller bearings

Bearing No. N 214

Size	70x110.5x24 mm
Bore Diameter	70 mm
Outer Diameter	110.5 mm
Width	24 mm
d	70 mm
D	125 mm
Ew	110.5 mm
B	24 mm
r min.	1.5 mm
r1 min.	1.5 mm
Weight	1.14 Kg
Basic dynamic load rating (C)	83 kN
Basic static load rating (C0)	95 kN
(Grease) Lubrication Speed	5000 r/min

N 214 Bearing 2D drawings and 3D CAD models